

# Product Information Structurally Optimized Lintel System HELLA trav plus

Excellent thermal insulation  
Saving of overlays  
Available for all wall thicknesses and numerous special designs  
Plaster base optionally HWL, EPS  
Guaranteed safe fixing of the plaster  
Environmentally friendly product

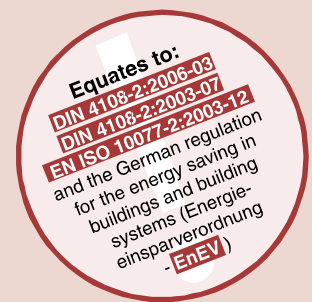

### 1 Plaster base at the rear

- Wood wool light building board (HWL), 25 mm, cement-bound
- Stability for the box
- Excellent plaster base (well-established)
- Solid fixing foundation

### 2 Insulation body made of EPS-15 (expanded polystyrene-particle foamed material)

- Optimum thermal insulation due to compact polystyrene block
- No thermal bridge to the inside
- Free of CFCs, HCFCs and fluorinated hydrocarbons
- Variable for a precise adjustment to the respective wall thickness
- Inflammability class in accordance with Austrian standard (ÖNORM) B 3800 or DIN 4102 (B1 - low flammability)
- Frost-proof, impervious to moisture, diffusion-open

### 3 Box made of galvanised sheet steel, 1 mm thick

- Precise form
- Self-supporting formwork - up to 1,500 mm without support

### 4 Insulation of the ceiling made of EPS-15

- As a standard with 20 mm, variabel for a surcharge!
- No thermal bridge to the solid ceiling due to compact polystyrene block

### 5 Plaster base at the front, optionally made of

- Wood wool light building plate (HWL), 20 mm
- EPS-30, 20 mm

### 6 Receiving cassette for insect rollerscreen

### 7 Plastic limit stop profile

- Defined limit stop position for the window
- No thermal bridge
- Bracket element for the integrable insect roller screen

### 8 Lateral support

- Made of wood wool light building plate, 20 mm, cement-bound

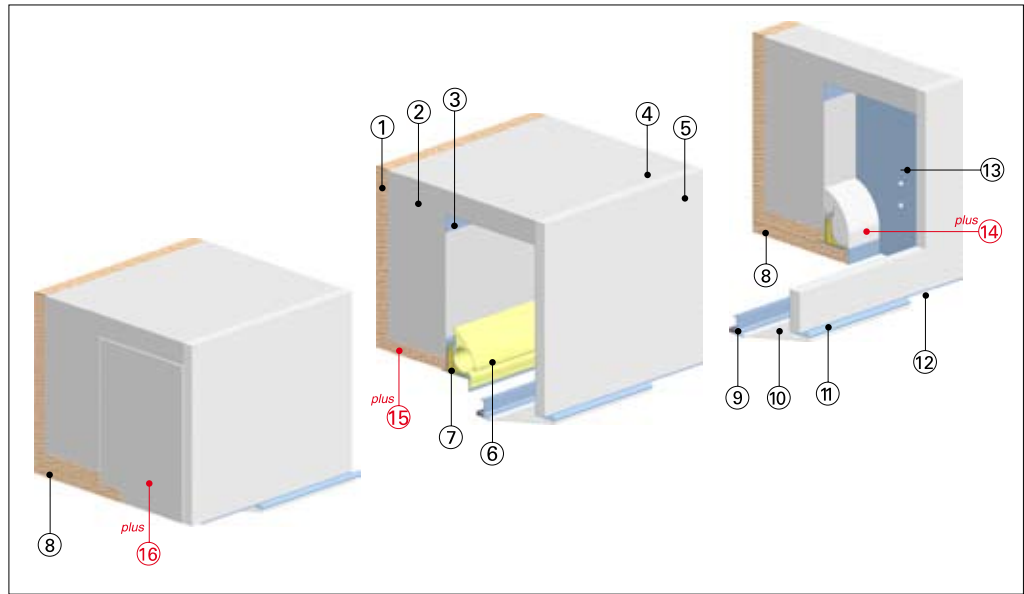

- Standard 120 mm
- Precise support when walling
- Better covering of the sub-frame due to an off-set of 20 mm

### 9 Brush profile

- Optimum sealing towards the roller shutter steel jacket
- Integration of the maintenance flap

### 10 Maintenance flap at the outside

- Made of aluminium sheet steel 1.2 mm
- No thermal bridge to the inside
- No pollution or damaging in the interior during maintenance works

### 11 Plaster flange

- As a standard 5 mm; variabel if requested
- Clear plaster edge

### 12 Lateral release device

- Support width plus plaster thickness
- Prevention of cracks in the plaster

### 13 Side part made of sheet steel

- 1 mm galvanised
- High stability
- Pre-assembled spot weld nuts for optimum installation of the sun protection

### 14 Basic profile of the insulation body made of EPS-30

- For a better insulation of the area of the limit stop of the window (not in connection with an insect roller screen cassette!)

### 15 Wood wool light building plate

- 20 mm thick, for a better stability of the box

### 16 Side part of the insulation body made of EPS-15

- As a standard with 40 mm, variabel for a surcharge!
- Clearly better insulation performance!

## Special forms

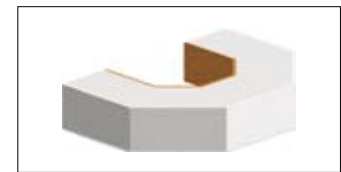

for bays



for horizontal arches



for sloping windows



for segmental and semicircular arches

## Additional insulation possibilities

The following insulation possibilities are available for a surcharge

(each additional insulation can be selected separately):



Insulation wedge with installation of roller shutters



Insulation body with installation of Venetian blinds

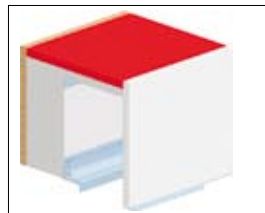

Additional insulation of the ceiling



for segmental and semicircular arches

Qualified company:

Head Office:  
HELLA Sonnen- und Wetterschutztechnik GmbH  
A-9913 Abfaltersbach 125  
T. +43 (0)4846 / 65 55-0  
F. +43 (0)4846 / 65 55-134  
E: office@hella.info

www.hella.info